



## **.26 Newcroft Close , UB8 3RJ**

**£2,352 PCM**

**\*\*STUDENTS\*\***

**4 BEDROOMS - AVAILABLE 24/07/2026**

The rental payments equate to approx £588 per person per month or £136 per person per week excluding bills. UniHomes offer a bills package for £26 per person per week. (Incl Gas, Electric, Water, TV licence and internet) which can be organised through Nupad initially.

COUNCIL TAX BAND D  
EPC D

Nupad offer this excellent FOUR-bedroom house comprising of FOUR FURNISHED BEDROOMS , a LOUNGE, 2 BATHROOMS one upstairs one downstairs, KITCHEN dining room, outside there is of street parking to the front and a rear garden.

The property is ideal for students at Brunel University as it's walking distance to the university. It is also nearby to direct bus routes to Uxbridge Town Centre, Heathrow, Stockley Park and the local underground station, which provides further access to Central London.

## .26 Newcroft Close, UB8 3RJ



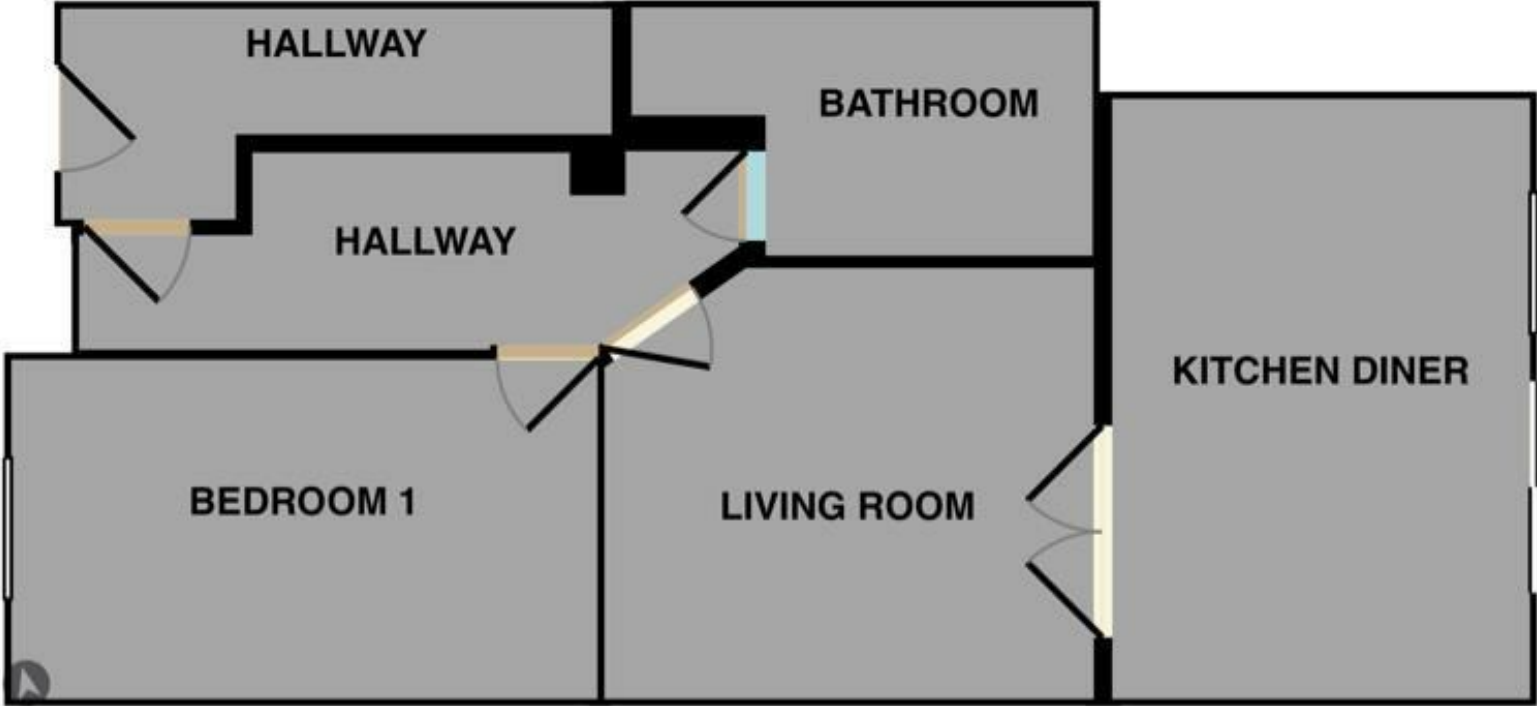

| Energy Efficiency Rating                    |           |
|---|-----------|
|   | Potential |
| Very energy efficient - lower running costs |           |
| (92 plus) <b>A</b>                          |           |
| (81-91) <b>B</b>                            |           |
| (69-80) <b>C</b>                            |           |
| (55-68) <b>D</b>                            |           |
| (39-54) <b>E</b>                            |           |
| (21-38) <b>F</b>                            |           |
| (1-20) <b>G</b>                             |           |
| Not energy efficient - higher running costs |           |
| <b>60</b>                                   | <b>81</b> |
| EU Directive 2002/91/EC                     |           |

| Environmental Impact (CO <sub>2</sub> ) Rating                  |           |
|---|-----------|
|   | Potential |
| Very environmentally friendly - lower CO <sub>2</sub> emissions |           |
| (92 plus) <b>A</b>  |           |
| (81-91) <b>B</b>  |           |
| (69-80) <b>C</b>  |           |
| (55-68) <b>D</b>  |           |
| (39-54) <b>E</b>  |           |
| (21-38) <b>F</b>  |           |
| (1-20) <b>G</b>   |           |
| Not environmentally friendly - higher CO <sub>2</sub> emissions |           |
| <b>53</b>   | <b>77</b> |
| EU Directive 2002/91/EC   |           |